

SPECIFICATION OF WCM-SCMSO, SCMESO SERIES

FEATURES

1. Low DCR and excellent impedance characteristics.
2. High rated current.
3. Excellent common mode EMI noise suppression.
4. Virtually no distortion of signals.



APPLICATIONS

1. EMI suppression for power line , AC/DC adaptor, larger electronic equipment, personal computers, peripherals, IoT etc.

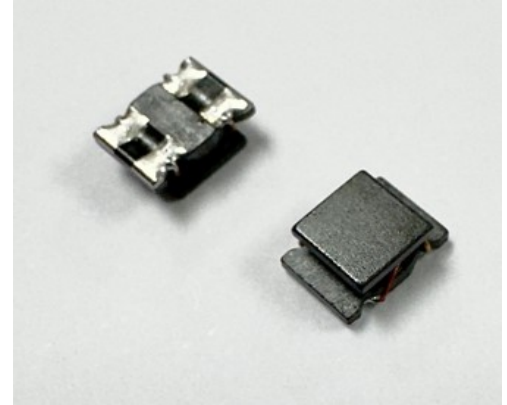

ORDERING CODE

WCM - 5025 SCMSO - 501 T
 (1) (2) (3) (4) (5)

- (1) PRODUCT TYPE CODE
- (2) PRODUCT SIZE CODE
- (3) DESIGN CODE
- (4) IMPEDANCE
- (5) REEL TAPING

ELECTRICAL SCHEMATIC

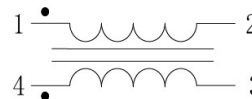

PAD LAYOUT

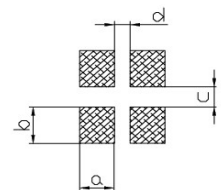

WCM-SCMSO

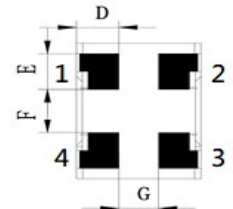
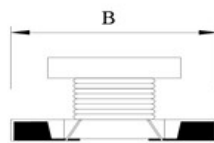
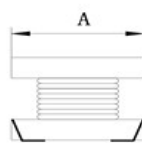

WCM-SCMESO

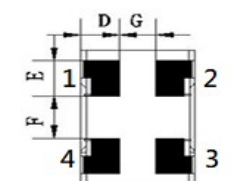
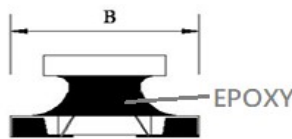
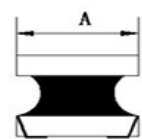

SHAPE & DIMENSIONS

UNIT:mm

SIZE CODE	A ±0.30	B ±0.30	C ±0.15	D Ref.	E Ref.	F Ref.	G Ref.	a	b	c	d
WCM-5025SCMSO	3.60	5.00	2.35	1.25	1.70	1.60	1.00	1.80	2.40	1.20	0.80
WCM-5025SCMESO	3.60	5.00	2.35	1.25	1.70	1.60	1.00	1.80	2.40	1.20	0.80

※All the data listed in this catalogue are for reference only, King Core reserves the right to alter or revise the specifications without prior notification.

COMMON MODE CHOKE → WCM-5025SCMSO SERIES

ELECTRICAL CHARACTERISTIC

ORDERING CODE	Impedance	Impedance	DC Resistance	IDC	Rated Voltage	Withstand Voltage	Insulation Resistance
	(Ω)±25%	(Ω)Typ	(Ω)	(A)	(V)	(V)	(MΩ)
	10MHz	100MHz	max.	Typ.	max.	max.	min.
WCM-5025SCMSO-231T	22	230	0.027	4.0	50	125	10
WCM-5025SCMSO-401T	35	400	0.034	2.5	50	125	10
WCM-5025SCMSO-501T	55	500	0.056	2.0	50	125	10
WCM-5025SCMSO-272T	100	2700	0.120	1.0	50	125	10

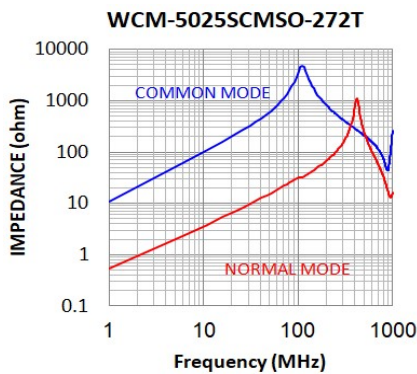
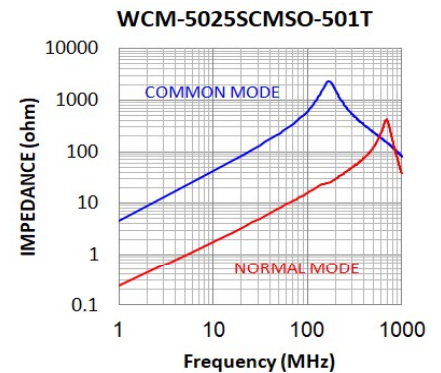
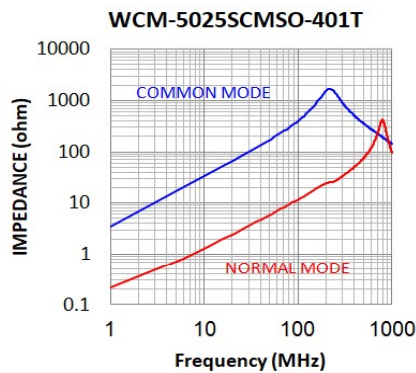
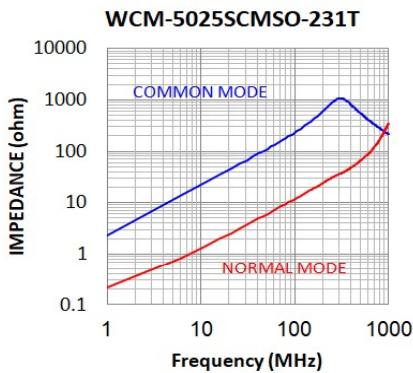

※IDC:Based on Temperature increase 40°C Typ.

※Operating temperature range : -40 to +125°C

※All the data listed in this catalogue are for reference only, King Core reserves the right to alter or revise the specifications without prior notification.

COMMON MODE CHOKE → WCM-5025SCMESO SERIES

ELECTRICAL CHARACTERISTIC

ORDERING CODE	Impedance	Impedance	DC Resistance	IDC	Rated Voltage	Withstand Voltage	Insulation Resistance
	(Ω)min.	(Ω)Typ	(Ω)	(A)	(V)	(V)	(M Ω)
	10MHz	100MHz	max.	Typ.	max.	max.	min.
WCM-5025SCMESO-500T	4.6	50	0.013	6.0	50	125	10
WCM-5025SCMESO-151T	11	150	0.020	5.0	50	125	10
WCM-5025SCMESO-331T	20	330	0.027	4.0	50	125	10
WCM-5025SCMESO-501T	35	500	0.034	2.5	50	125	10
WCM-5025SCMESO-112T	50	1100	0.056	2.0	50	125	10

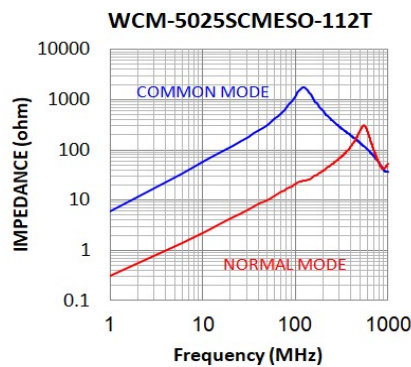
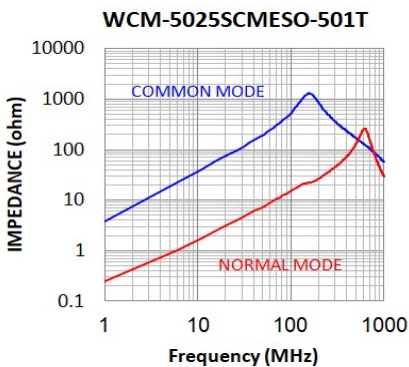
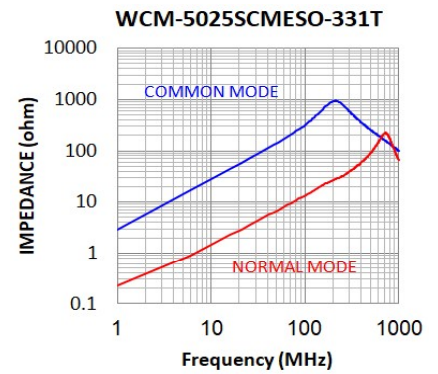
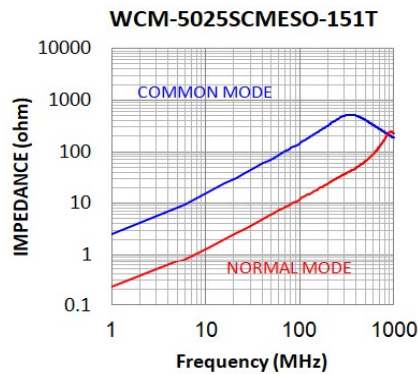
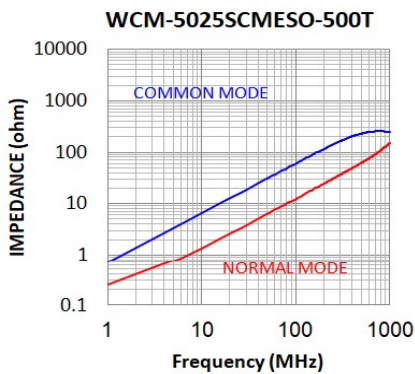

※IDC: Based on Temperature increase 40°C Typ.

※Operating temperature range : -40 to +125°C

※All the data listed in this catalogue are for reference only, King Core reserves the right to alter or revise the specifications without prior notification.